

**SPICER HEAVY AXLE
QUICK REFERENCE GUIDE**

SPICER®



Features and Benefits
Popularity Listings
Dimensional Data

HX500-QR
DECEMBER, 1997

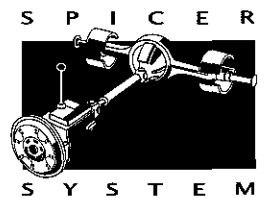
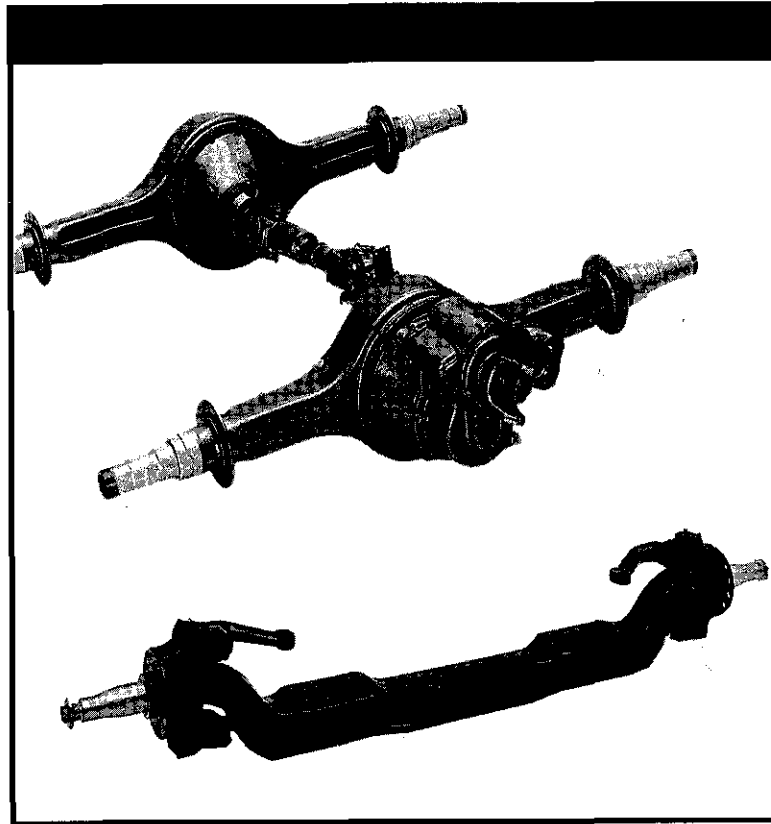

TABLE OF CONTENTS

Front Axle Identification	3
Rear Axle Identification	3
Spicer Heavy Axle Production Key	4
Front Axle King Pin Kits	5
Front Axle I-Beams	8
Tie Rod Ends	9
Genuine O.E.M. Ring Gear and Pinion Cost Competitive Kits	11
Ring & Pinion Gear Sets	12
How to Change Gear Ratios	15
Power Divider Kits	17
Differential Parts Kits	18
Differential Case Kits	19
Spicer Differential Major Overhaul Kits	20
Rear Axle Seal Changes & Supersessions	21
Half Round Rear Axle End Yoke Changes & Supersessions	22
New Exchange Carrier Assemblies	23

**Note: All Spicer Gold "S" Series products are available only through
O.E. channels of distribution.
All Spicer "N" Series products are available only through Navistar.**

FRONT AXLE IDENTIFICATION

FRONT AXLE IDENTIFICATION

The Spicer front non drive steering axles are identified with a tag located between the spring pads, on the front side of the center beam section.

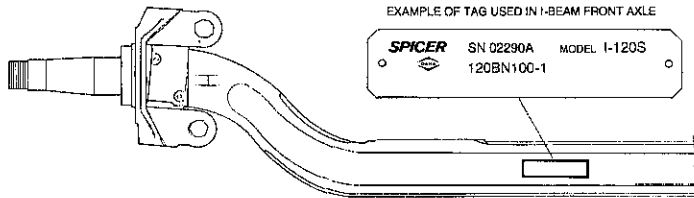

The axle tag contains the serial number, the model number, and the assembly number.

SPICER HEAVY AXLE MODEL NUMBERING SYSTEM

The Spicer model numbering system provides pertinent information about the axle for easy identification. For example:

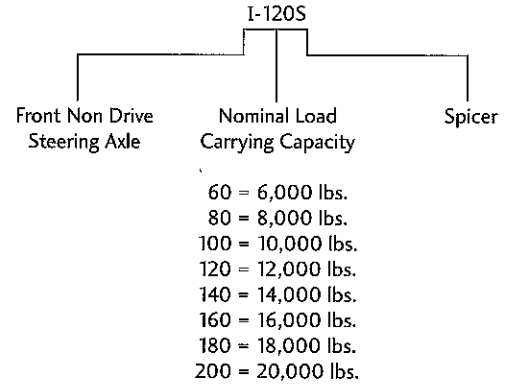

REAR AXLE IDENTIFICATION

REAR AXLE IDENTIFICATION

All Spicer heavy axle assemblies are identified with two tags. One located on the differential carrier, and the other on the other on the right front leg of the banjo housing.

The carrier tag contains the serial number, the carrier assembly number, and the ratio.

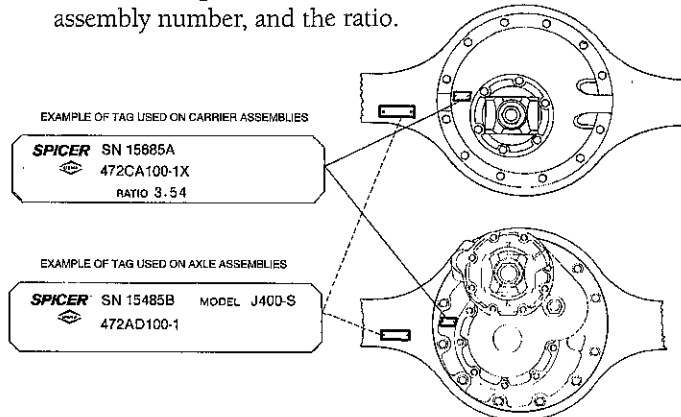

The housing tag contains the serial number, model number, and the axle assembly number.

SPICER HEAVY AXLE MODEL IDENTIFICATION

The Spicer model numbering system provides pertinent information about the axle for easy identification. For example:

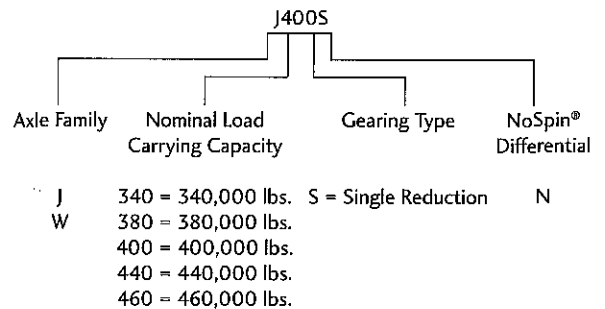

SPICER HEAVY AXLE PRODUCTION KEY

NON-DRIVE FRONT AXLES

Spicer Model	G.A.W.R.	Production Dates
I50	5,000	Pre 1989
I60	6,000	Pre 1990
I60	6,000	1989 to current
I60	6,000	1992 to current
I75	7,500	Pre 1990
I75	7,500	Pre 1987
I80	8,000	Pre 1990
I80	8,000	1988 to current
I90	9,000	Pre 1990
I100	10,000	1988 to current
I108	10,800	Pre 1990
I120	12,000	Pre 1990
I120	12,000	Pre 1987
I120	12,000	1988 to current
I120 Deep	12,000	1989 to current
I132	13,500	1987 to 1990
I140	14,000	1988 to current
I160	16,000	1991 to current
I180	18,000	1991 to current
I200	20,000	1991 to current

SINGLE SPEED REAR AXLES

Spicer Model	G.A.W.R.	Production Dates
F155	10,000	1987 to 1997
F155	12,000	1987 to 1997
F155	13,000	1987 to 1997
F155	15,500	1987 to 1997
F170	17,000	Pre 1989
G175	17,500	Pre 1989
G190	19,000	Pre 1988
J175	17,500	1976 to current
J190	17,500	1976 to current
J190	19,000	1976 to current
J210	21,000	1976 to current
J220	22,000	1976 to current
M185/M190	19,000	Pre 1987
M220	22,000	Pre 1989
N175*	15,500	1992 to current
N175*	15,900	1992 to current
N175*	17,500	1988 to current
N175*	17,500	1990 to current
N190*	16,900	1992 to current

SINGLE SPEED REAR AXLES

Spicer Model	G.A.W.R.	Production Dates
N190*	17,500	1988 to current
N190*	19,000	1989 to current
N190SP*	19,800	1989 to current
N210*	21,000	1989 to 1994
S100*	10,000	1994 to current
S122*	12,200	1994 to current
S135*	13,500	1994 to current
S150*	15,500	1994 to current
S230*	23,000	1994 to current
S230SL*	23,000	1994 to current
W230	23,000	1986 to current
W230SP	23,000	Pre 1986
S230SL*	23,000	1994 to current

TANDEM REAR AXLES

Spicer Model	G.A.W.R.	Production Dates
G300	30,000	Pre 1986
G340	34,000	Pre 1986
G380	38,000	Pre 1986
J340	34,000	1986 to 1990
J380	38,000	1986 to 1990
J400	40,000	1986 to current
N340*	34,000	1989 to current
N400*	40,000	1988 to current
S230SL/T200*	40,000	1994 to current
S400, Standard axle*	40,000	1994 to current
S400 w/lube pump*	40,000	1994 to current
S400 Standard axle w/215 wheel end*	40,000	1994 to current
S400SL w/driver controlled differential*	40,000	1994 to current
S400SL w/lube pump, differential lock*	40,000	1994 to current
W460	46,000	1986 to current

TWO SPEED REAR AXLES

Spicer Model	G.A.W.R.	Production Dates
G155T	15,500	1989 to current
G175T	17,500	1986 to current
M190T	19,000	1986 to current
M210T	21,000	1986 to current
M220T	22,000	1986 to current

Note: All Spicer Gold "S" Series products are available only through O.E. channels of distribution.
All Spicer "N" Series products are available only through Navistar.

* Not available to independent aftermarket

FRONT AXLE KING PIN KITS

12 KITS COVER 28 AXLE MODELS

Available nationwide at authorized Spicer locations are premium pre-sized king pin service kits for the most popular Spicer front axles. Twelve (12) pre-sized kit packages cover twenty-eight (28) models for excellent truck application coverage.

The improvements and value-added benefits to Spicer customers are numerous — with proper installation and maintenance, the premium kit will more than double the service life* in a variety of vocations over existing standard replacement and competitive bronze bushing kits.

For Spicer customers that demand nothing less than the best bushing technology available in the industry today, install Spicer premium king pin service kits.

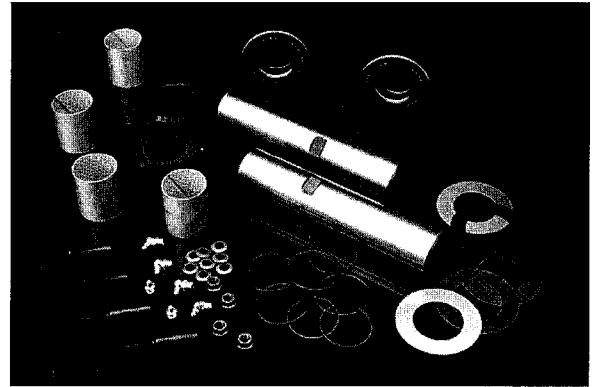

PRE-SIZED, EXACT FIT BUSHINGS

Being pre-sized, no special calibrating, honing or reaming is required by service personnel — allowing Spicer customers to get in and out of the service area with reduced time for installation. The previous time allocated for using special tools and preparation for old style kits has been eliminated.

PREMIUM FEATURES AND BENEFITS

Premium versus Standard Bronze Type

Spicer premium pre-sized bushings are made with an acetal polymer lining with staggered grease pockets for uniform king pin lube distribution. The acetal liner is used in combination with a steel backing for strength and a layer of porous bronze for excellent heat dissipation. Service replacement costs over standard bronze type bushings are competitive when installation labor is included. This minimal expense is more than off-set by the positive advantages of considerably longer life, extended lube intervals and low-friction easier steering effort. Being more than a basic replacement bushing to simply get by, pre-sized bushings are a proven premium product for those demanding the best.



lubrication. Nine (9) Spicer pre-sized king pin kits now contain upper and lower bushing seals that are easily installed during reassembly. The lower bushing seal has been added to the Senior Axle kits at no additional cost.** Sealing off the lower bushing cannot be done with current competitive bronze type kits.

Excellent Sealing Characteristics

A major cause of accelerated king pin wear is contamination or harsh abrasives entering into areas where there should be only

*Based on Garlock Bearings, Inc. direct comparison wear life tests.

**Upper and lower seals are now included in nine (9) kits for the popular Senior Series.

FRONT AXLE KING PIN KITS (cont'd)

Less Steering Effort

Spicer line haul class 8 front axle models are designed with larger diameter king pins and bushings for greater axle stability and extended service life. When this design is combined with proven low-friction king pin bushings that incorporate balanced internal lubrication characteristics, the result is a smoother, easier steering effort or turning force under a variety of driving conditions.

Extended Lube Intervals to 18,000 Miles

Once premium pre-sized kits have been installed, maintenance lube intervals are extended to 18,000 miles versus the current 10,000 mile recommendation on competitive bronze bushings. This unique bushing lubrication design provides maximum utilization and protection of the lube at installation and dramatically reduces future maintenance time and related expense.

SIMPLE INSTALLATION

In all Spicer non-driving steer axles, pre-sized bushing installation is simple:

1. Remove knuckles as outlined in maintenance procedures and remove old bushing using an appropriate bushing installer/remover.
2. Clean and inspect the knuckle for excessive wear or damage.
3. Using a small clean brush or fingers, take some of the specified lube and completely fill or coat the polymer pockets on the inside of the bushing. Hand start bushing into king pin bores.
4. Using a bushing installer, press bushings to dimensions for axle model being serviced. Install and carefully press upper and lower seals until flush with knuckle bore surface.

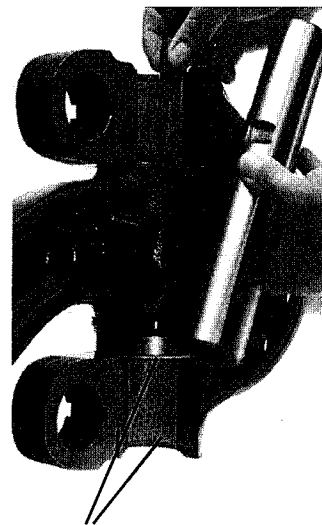
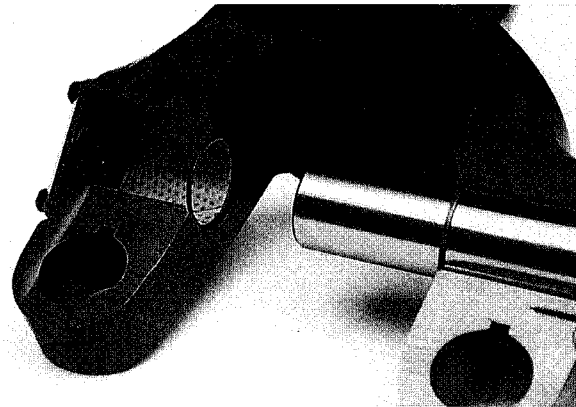
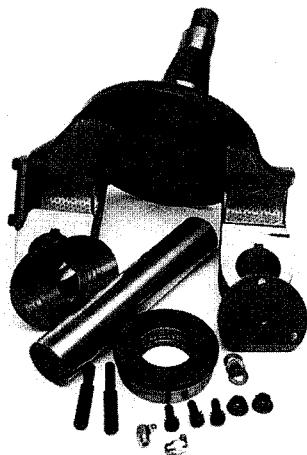

Upper and lower seals are now included in nine (9) kits for the popular Senior Series.

FRONT AXLE KING PIN KITS

Spicer Model	Spicer Part Number	Size*	Bushing Type**	Pin Type***	Pin Length	Pin Diameter
150	101KK109	Standard	G	S	7.97	1.359
	101KK110	.002/OS	G	S	7.97	1.361
160	101KK109	Standard	G	S	7.97	1.359
	101KK110	.002/OS	G	S	7.97	1.361
	101KK111	Standard	G	D	7.97	1.359
175	101KK109	Standard	G	S	7.97	1.359
	101KK110	.002/OS	G	S	7.97	1.361
	101KK111	Standard	G	D	7.97	1.359
180	101KK111	Standard	G	D	7.97	1.359
	101KK110	.002/OS	G	S	7.97	1.361
190	337KK103	.002/OS	G	S	9.16	1.611
	309KK102	Standard	G	D	9.16	1.609
	493092C92	.002/OS	B	S	8.85	1.486
	591945C92	Standard	B	D	8.85	1.484
1100	120KK100	Standard	G	D	9.87	1.921
1108	337KK104	.002/OS	G	S	9.66	1.611
	343KK103	Standard	G	D	9.66	1.609
1120	120KK100	Standard	G	D	9.87	1.921
	337KK104	.002/OS	G	S	9.66	1.611
	343KK103	Standard	G	D	9.66	1.609
1132	337KK104	.002/OS	G	S	9.66	1.611
1135	337KK104	.002/OS	G	S	9.66	1.611
1140	140KK100	Standard	G	D	10.12	2.046
1160	220KK100	Standard	G	D	11.00	2.046
1180	220KK100	Standard	G	D	11.00	2.046
1200	220KK100	Standard	G	D	11.00	2.046

* OS = Oversize Screen

** Bushing Type: B = Bronze, G = Presized Garlock

*** Pin Type: S = Single draw key, D = Dual draw key

SUSPENSION & STEERING

FRONT AXLE I-BEAMS

FEATURES

- All Spicer service I-beams are genuine original equipment, the exact same high quality components used in production Spicer front axle assemblies.
- Made from high strength, heat-treated, fine grain forgings
- Stiffest beam in the industry
- Reduces tire wear
- Lightest weight steel I-beam in the industry

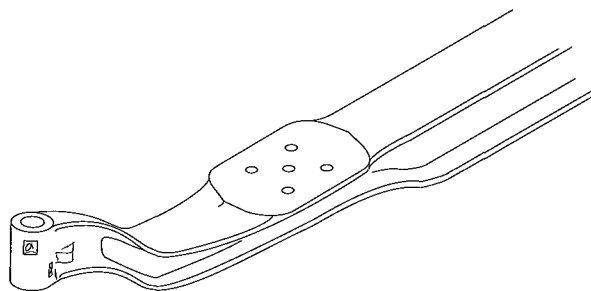

FRONT AXLE I-BEAMS			
Spicer Model	Spicer Part Number	G.A.W.R.	Notes
150, 160	441219C1	5,000, 6,000	Loadstar
	465813C1	5,000, 6,000	S-Series
175	101 TB102	7,500	Loadstar
175, 180	101 TB104	7,500, 8,000	S-Series
190	584277C1	9,000	S-Series
	586120C1	9,000	Loadstar
1108, 1120, 1135	584206C1	9,000, 10,800, 12,000, 13,500	Straight Center I-Beam for S-Series without CAT-3208 Engine and except Model 1853FC
1108, 1120	584273C1	10,800, 12,000	
	584274C1	9,000, 10,800, 12,000	S-Series with CAT-3208 Engine and Model 1853FC
	586124C1	10,800, 12,000	Loadstar

SUSPENSION & STEERING

TIE ROD ENDS

FEATURES

- Steering pivot points which accommodate rotational and angular motion.
- Provide torque control and automatic wear adjustment.
- Forged, not cast, for strength
- Precision loaded with a belleville spring to maintain tolerance
- Large diameter shaft to reduce deflection
- OEM Engineered Quality

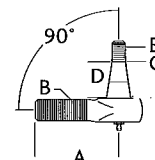
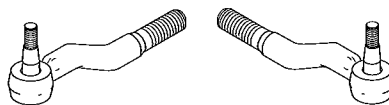

TIE ROD ENDS

Spicer Model	G.A.W.R.	Side	Part No.	A Length Thread	B Rod Diameter	C Small Length	D Taper Thread	E Stud
150	6,000	RH	080TR117	4.43	1-16R	0.783	0.928	3/4-16
		LH	080TR116	4.43	1-16L	0.783	0.928	3/4-16
160		RH	080TR117	4.43	1-16R	0.783	0.928	3/4-16
		LH	080TR116	4.43	1-16L	0.783	0.928	3/4-16
170	7,000	RH	080TR117	3.88	1-16R	0.664	0.848	5/8-18
		LH	080TR116	3.88	1-16L	0.664	0.848	5/8-18
175	7,500	RH	080TR117	3.88	1-16R	0.664	0.848	5/8-18
		LH	080TR116	3.88	1-16L	0.664	0.848	5/8-18
		RH	080TR117	4.43	1-16R	0.783	0.928	3/4-16
		LH	080TR116	4.43	1-16L	0.783	0.928	3/4-16
190	9,000	RH	140TR110	9.18	1-1/8-12R	0.967	1.080	7/8-14
		LH	140TR109	9.18	1-1/8-12L	0.967	1.080	7/8-14
		RH	140TR110	4.88	1-1/8-12R	0.967	1.080	7/8-14
		LH	140TR109	4.88	1-1/8-12L	0.967	1.080	7/8-14
		RH	140TR110	4.88	1-1/8-12R	0.967	1.080	7/8-14
		RH	140TR110	9.18	1-1/8-12R	0.967	1.080	7/8-14
		LH	140TR109	9.18	1-1/8-12L	0.967	1.080	7/8-14
		LH	140TR109	9.18	1-1/8-12L	0.967	1.080	7/8-14
1108	10,800	RH	140TR110	9.18	1-1/8-12R	0.967	1.080	7/8-14
		LH	140TR109	9.18	1-1/8-12L	0.967	1.080	7/8-14
1120	12,000	RH	140TR110	9.18	1-1/8-12R	0.967	1.080	7/8-14
		LH	140TR109	9.18	1-1/8-12L	0.967	1.080	7/8-14
		RH	140TR110	9.18	1-1/8-12R	0.967	1.080	7/8-14
		LH	140TR109	9.18	1-1/8-12L	0.967	1.080	7/8-14

SUSPENSION & STEERING

TIE ROD ENDS (cont'd)

TIE ROD ENDS (continued)								
Spicer Model	G.A.W.R.	Side	Part No.	A Length	B Rod Thread	C Small Diameter	D Taper Length	E Stud Thread
I132	13,200	RH	140TR110	5.44	1-1/8-12R	0.967	1.080	7/8-14
		LH	140TR109	5.44	1-1/8-12L	0.967	1.080	7/8-14
I140	14,000	RH	140TR110	9.18	1-1/8-12R	0.967	1.080	7/8-14
		LH	140TR109	9.18	1-1/8-12L	0.967	1.080	7/8-14
I160	16,000	RH	220TR116	5.75	1-1/4-12R	1.080	1.410	7/8-14
		LH	220TR115	5.75	1-1/4-12L	1.080	1.410	7/8-14
		RH	220TR119	12.69	1-1/4-12R	1.080	1.410	7/8-14
		LH	220TR118	12.69	1-1/4-12L	1.080	1.410	7/8-14
I180	18,000	RH	220TR116	5.75	1-1/4-12R	1.080	1.410	7/8-14
		LH	220TR115	5.75	1-1/4-12L	1.080	1.410	7/8-14
		RH	220TR119	12.69	1-1/4-12R	1.080	1.410	7/8-14
		LH	220TR118	12.69	1-1/4-12L	1.080	1.410	7/8-14
I200	20,000	RH	220TR116	5.75	1-1/4-12R	1.080	1.410	7/8-14
		LH	220TR115	5.75	1-1/4-12L	1.080	1.410	7/8-14
		RH	220TR119	12.69	1-1/4-12R	1.080	1.410	7/8-14
		LH	220TR118	12.69	1-1/4-12L	1.080	1.410	7/8-14

GENUINE O.E.M. RING GEAR AND PINION COST COMPETITIVE KITS

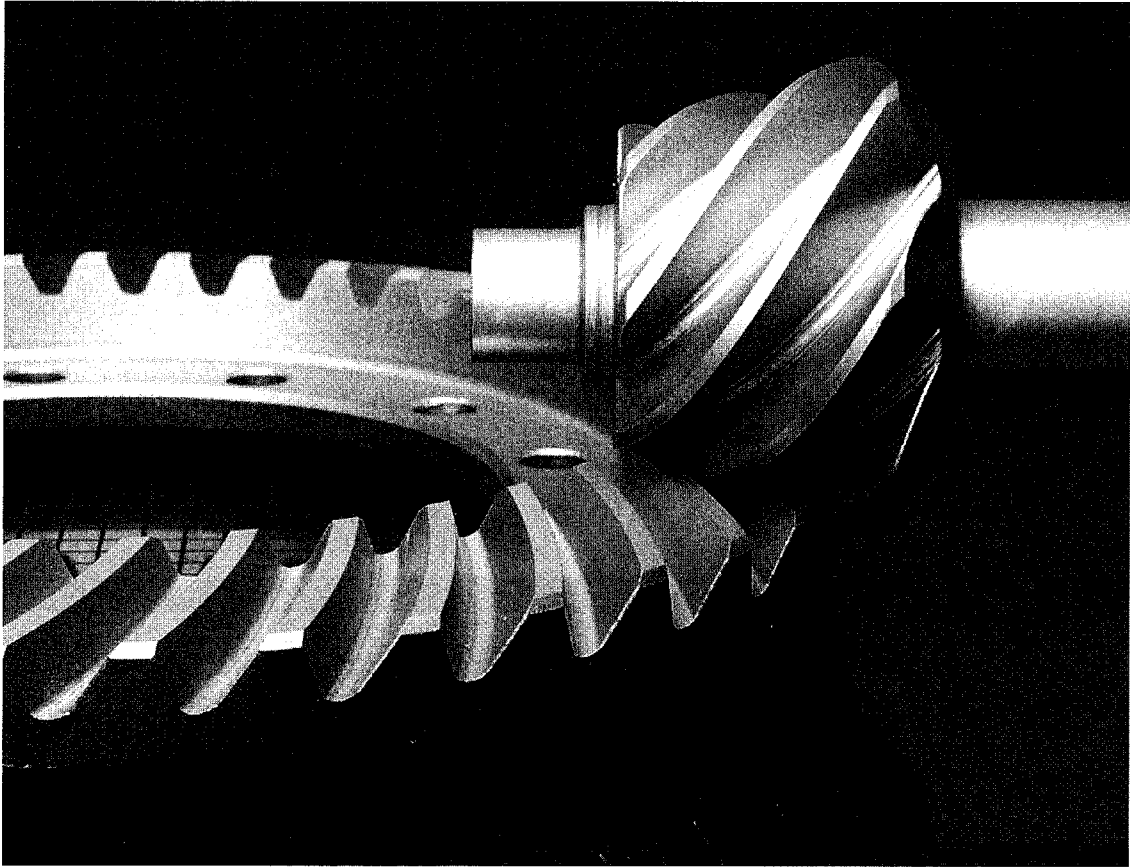

Compare Our Pricing on 80 Plus Kits

Spicer now offers over 80 ring gear and pinion kits for customers that desire genuine O.E.M. parts. All Spicer kits are manufactured under the same rigid O.E. specifications as the original ring gear and pinion. This assures minimum vibration level within the truck's complete balanced drivetrain system. The best part for service replacement is an original part and at a very competitive price. All Packaged kits also contain a new pinion nut and are easier to setup to original engineering specifications.

The non-original "will fits" cannot offer the same engineering specs to insure top performance and service life. Each ring gear and pinion kit is precisely matched for optimum

gear contact pattern by the Spicer Heavy Axle and Brake Division of Dana Corporation.

These 80 PLUS kits are immediately available through the Spicer distribution network. This, as well as all other related parts, gives the customer the highest standard in quality and long life dependability for the lowest price possible — all from one source.

Spicer offers a 12 month, unlimited miles warranty.

See the following pages for complete listing of sizes and ratios.

RING & PINION GEAR SETS

FEATURES

- Heat-treated high strength forged gears, not cast
- Matched sets for easy set-up
- Original equipment, not aftermarket
- 80+ part numbers available through your distribution center
- Pinion nut included at no additional cost
- Competitively priced to aftermarket gears

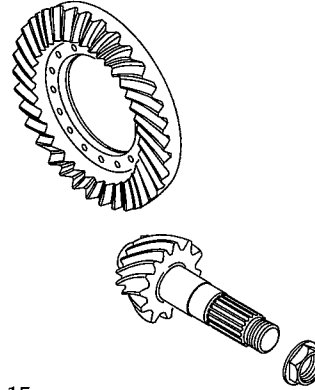

NOTE: When changing ratios, refer to "How to Change Gear Ratios" on page 15.
 As of 1993 ring gear bolts are used. Rivets were used before 1993.
 You can replace rivets with bolts (refer to page 14)

RING & PINION GEAR SETS							
Spicer Model	Ring Gear Bolt Kit Number	Spicer Part Number	Ratio	Spicer Model	Ring Gear Bolt Kit Number	Spicer Part Number	Ratio
F155S	401KY101X	039KG100X	4.33	G340, G380, J340S, J380S, J400S	401KY101X	597236C91	3.54
		029KG100X	4.78			597237C91	3.73
		029KG101X	5.57			597238C91	3.91
		029KG102X	6.50			597239C91	4.10
		029KG103X	7.17			597240C91	4.44
		586152C91	4.78			597241C91	4.78
		68906R94	5.57			597242C91	5.38
		68907R94	6.50			597243C91	6.14
		68908R94	7.17			597244C91	6.57
						597245C91	7.17
						597246C91	8.17
F170S	401KY101X	586152C91	4.78	J190S	401KY101X	597236C91	3.54
		68906R94	5.57			597237C91	3.73
		68907R94	6.50			597238C91	3.91
		68908R94	7.17			597239C91	4.10
		039KG100X	4.33			597240C91	4.44
		029KG100X	4.78			597241C91	4.78
		029KG101X	5.57			597242C91	5.38
		029KG102X	6.50			597243C91	6.14
		029KG103X	7.17			597244C91	6.57
						597245C91	7.17
						597246C91	8.17
G155T, G175T	Not Applicable	GGAKG127X	4.56				
		GGAKG117X	4.89				
		GGAKG118X	5.57				
		GGAKG119X	6.17				
		GGAKG120X	6.50				

RING & PINION GEAR SETS (continued)

Spicer Model	Ring Gear Bolt Kit Number	Spicer Part Number	Ratio	Spicer Model	Ring Gear Bolt Kit Number	Spicer Part Number	Ratio
J175S, J190S,	401 KY101 X	597236C91	3.54	N175*, N190*,	401 KY101 X	401 KG136X	5.63
J210S, J220S		597237C91	3.73	N210*		401 KG127X	6.14
		597238C91	3.91			401 KG132X	6.50
		597239C91	4.10			401 KG133X	7.17
		597240C91	4.44				
		597241 C91	4.78	N340*, N400*	401 KY101 X	401 KG100X	3.06
		1694169C91	5.11			401 KG101 X	3.21
		597242C91	5.38			401 KG102X	3.42
		1694169C91	5.63			401 KG103X	3.54
		597243C91	6.14			401 KG104X	3.73
		597244C91	6.57			401 KG105X	3.97
		597245C91	7.17			401 KG106X	4.10
		597246C91	8.17			401 KG107X	4.44
						401 KG109X	4.78
M230T	Not Applicable	MJAKG132X	4.11/5.60			401 KG128X	5.11
		MJAKH133X	4.56/6.21			401 KG112X	5.38
		MJAKG119X	4.89/6.66			401 KG135X	5.63
		MJAKG134X	5.29/7.21			401 KG126X	6.14
		MJAKG120X	5.57/7.60			401 KG113X	3.06
		MJAKG121 X	6.14/8.38			401 KG114X	3.21
		MJAKG122X	6.50/8.87			401 KG115X	3.42
		MJAKG123X	7.17/9.77			401 KG116X	3.54
						401 KG117X	3.73
M190T, M210T,	Not Applicable	MJAKG132X	4.11/5.60			401 KG118X	3.91
M220T		MJAKG133X	4.56/6.21			401 KG119X	4.10
		MJAKG119X	4.89/6.66			401 KG120X	4.44
		MJAKG134X	5.29/7.21			401 KG122X	4.78
		MJAKG120X	5.57/7.60			401 KG129X	5.11
		MJAKG121 X	6.14/8.38			401 KG125X	5.38
		MJAKG122X	6.50/8.87			401 KG136X	5.63
		MJAKG123X	7.17/9.77			401 KG127X	6.14
N175*, N190*,	401 KY101 X	401 KG116X	3.54	W230S	057KY101 X	597247C91	3.54
N210*		401 KG117X	3.73			597248C91	3.73
		401 KG118X	3.91			597249C91	3.91
		401 KG119X	4.10			597250C91	4.10
		401 KG120X	4.44			597251 C91	4.44
		401 KG122X	4.78			597252C91	4.78
		401 KG129X	5.11			597253C91	5.38
		401 KG125X	5.38			597254C91	6.14

Note: All Spicer Gold "S" Series products are available only through O.E. channels of distribution.

All Spicer "N" Series products are available only through Navistar.

* Not available to independent aftermarket

RING & PINION GEAR SETS (cont'd)

RING & PINION GEAR SETS (continued)							
Spicer Model	Ring Gear Bolt Kit Number	Spicer Part Number	Ratio	Spicer Model	Ring Gear Bolt Kit Number	Spicer Part Number	Ratio
W230S	057KY101X	597255C91	6.57	W460S	057KY101X	597251C91	4.44
		597256C91	7.17			597252C91	4.78
						597253C91	5.38
W460S	057KY101X	597247C91	3.54			597254C91	6.14
		597248C91	3.73			597255C91	6.57
		597249C91	3.91			597256C91	7.17
		597250C91	4.10				

Note: F, J, and N Model Axles

401KY101X Kit (1696994C91 - Navistar) M16 X 1.5 - 6G bolt. Torque to 300 - 320 lb. ft. (406 - 434 N-M)

Additional tooling may be required during bolt installation in the "N" Series axles. 6.50 thru 7.83 ratios, to prevent bolt head rotation.

W Model Axles

057KY101X Kit (1697352C91 - Navistar) M18 X 1.5 - 6G bolt. Torque to 300 - 320 lb. ft. (406 - 434 N-M)

S 230S Model Axle

300KY100X Kit (1697452C91 - Navistar) M18 X 1.5 - 6G bolt. Torque to 300 - 320 lb. ft. (406 - 434 N-M)

HOW TO CHANGE GEAR RATIOS

NOTE: A ratio change may cause a flange change. When changing ratios, you must check for case compatibility. Refer to the listing below for the appropriate case number. Also see the Ring and Pinion listing beginning on page 12 to select the proper Ring and Pinion number.

HOW TO CHANGE GEAR RATIOS

Spicer Model	Ratio	Flanged Half, Case Part Number
F155S, F175S	3.91	029DU101
	4.33	581550C1
	4.78	581550C1
	5.18	581550C1
	5.29	581550C1
	5.57	241282R1
	6.50	241282R1
	7.17	241282R1

G155T, G175T	4.56	GGADZ100
	4.89	GGADZ100
	5.57	GGADZ100
	6.17	GGADZ100
	6.50	GGADZ100
	7.17	GGADZ100

G175S Replaced by (Locked-out) 4.33**

G190S 2-speed carrier assembly	4.56	
	4.89	
	5.29	
	5.57	
	6.17	
	6.50	
	7.17	

J175S, J190S, J220S, G340, G380, G400	3.54	584281C1
	3.73	505756C1
	3.91	505756C1
	4.10	505756C1
	4.44	505756C1
	4.78	505757C1
	5.38	505757C1
	6.14	505757C1

Spicer Model	Ratio	Flanged Half, Case Part Number
J175S, J190S, J220S, G340, G380, G400	6.57	505757C1
	7.17	505757C1
	8.17	505757C1

M190S Replaced by (Locked-out) 3.70**

M190T, M210T, M220T, M230T	3.70	MJADZ100
	3.90	MJADZ100
	4.11	MJADZ100
	4.36	MJADZ100
	4.56	MJADZ100
	4.89	MJADZ100
	5.57	MJADZ100
	6.14	MJADZ100
	6.50	MJADZ100
	7.17	MJADZ100

M220S 2-speed carrier assembly 4.11

	4.56	
	4.89	
	5.29	
	5.57	
	6.17	
	6.50	
	7.17	

N175*, N190*, N210*	3.06	401 DU101
	3.21	401 DU101
	3.42	401 DU101
	3.54	401 DU101
	3.73	401 DU101
	3.91	401 DU101
	4.10	401 DU101
	4.44	401 DU101

Note: All Spicer Gold "S" Series products are available only through O.E. channels of distribution.

All Spicer "N" Series products are available only through Navistar.

* Not available to independent aftermarket

** Two speed carrier locked into high replaces single speed carrier.

HOW TO CHANGE GEAR RATIOS (cont'd)

HOW TO CHANGE GEAR RATIOS (continued)					
Spicer Model	Ratio	Flanged Half, Case Part Number	Spicer Model	Ratio	Flanged Half, Case Part Number
N175*, N190*, N210*	4.78	401DU103	S135S*, S150S*	4.44	360DU105
	5.11	401DU103		4.78	360DU107
	5.38	401DU103		5.38	360DU107
	5.63	401DU103		6.14	360DU109
	6.14	401DU103		6.43	360DU109
	6.50	401DU105		7.17	360DU109
	7.17	401DU105			
	7.83	401DU105	S230S*	3.07	300DU103
				3.21	300DU103
N340FWD*, N340RR*,	3.06	401DU101		3.73	300DU105
N400FWD*, N400RR*	3.21	401DU101		4.08	300DU105
	3.42	401DU101		4.44	300DU105
	3.54	401DU101		4.78	300DU107
	3.73	401DU101			
	3.91	401DU101	S400FWD*, S400RR*	2.81	390DU109
	4.10	401DU101		2.93	390DU109
	4.44	401DU101		3.07	390DU101
	4.78	401DU103		3.21	390DU103
	5.11	401DU103		3.42	390DU103
	5.38	401DU103		3.54	390DU103
	5.63	401DU103		3.73	390DU103
	6.14	401DU103		3.91	390DU105
	6.50	401DU105		4.10	390DU105
	7.17	401DU105		4.44	390DU105
	7.83	401DU105		4.78	390DU107
S135S*, S150S*	2.69	360DU101	W230S, W460S	3.54	584284C1
	2.81	360DU101		3.73	208523R5
				3.91	208523R5
S135S*, S150S*	2.92	360DU101		4.10	208523R5
	3.07	360DU101		4.44	208523R5
	3.21	360DU101		4.78	161091R5
	3.38	360DU103		5.38	161091R5
	3.54	360DU103		6.14	161091R5
	3.73	360DU103		6.57	161091R5
	3.91	360DU105		7.17	161091R5
	4.10	360DU105			

Note: All Spicer Gold "S" Series products are available only through O.E. channels of distribution.
 All Spicer "N" Series products are available only through Navistar.
 * Not available to independent aftermarket

POWER DIVIDER KITS

FEATURES

- Precision forged side gears and pinion mates
- High strength forged heat treated cross
- Heat treated pinion bushings
- New riveted case for more strength with less size

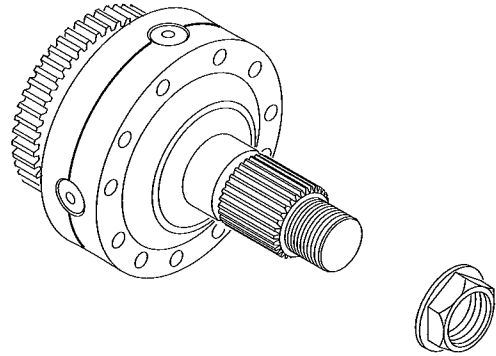

POWER DIVIDER KITS

Spicer Model	Spicer Part Numbers		
	Gears & Cross Kit	Cases, Bolts, Gears & Cross Kit	Housing, Cases, Bolts, Gears & Cross Kits
G341, G340, G380	R30KR101X	R30KR102X	R30KR103X with 3/8" housing bolt hole R30KR105X with 1/2" housing bolt hole
J380S, J400S, W460S	472KS102X	472KS104X	472KD111X
N340*, N400*	401KZ101X	Not Available	401KD100X
S400S*	Not Available	472DD102X 390KD101X	Not Available

Note: All Spicer Gold "S" Series products are available only through O.E. channels of distribution.
 All Spicer "N" Series products are available only through Navistar.
 * Not available to independent aftermarket

This list is not complete, check parts catalog for comprehensive list.

Riveted design power divider cannot be used with old style housing.

DIFFERENTIAL PARTS KITS

FEATURES

- Precision forged side gears and pinion mates
- High strength forged heat treated cross
- Heat treated pinion bushings
- Broached or rolled axle shaft splines

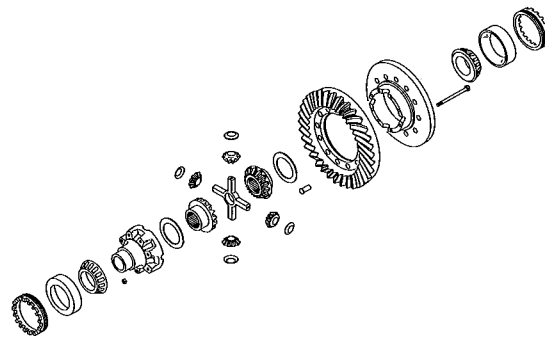

Note: Kit consists of (1) spider cross, (4) pinion gears and washers, and (2) axle gears and washers. Spider cross, pinion gears and axle gear are serviced only in kits.

DIFFERENTIAL PARTS KITS			
Spicer Model	Spicer Part Number	Spline Type	Spline Size
F155S	029KR100X	Straight Cut	1-3/4" x 16
	472KS106X	Rolled/Involute	1-7/8" x 36
F170S	029KR101X	Straight Cut	1-7/8" x 16
	472KS106X	Rolled/Involute	1-7/8" x 36
G155T, G175S, G175T	CGAKD101X	Rolled/Involute	1-7/8" x 36
G185S	CGAKD102X	Rolled/Involute	2" x 39
G300S	472KS106X	Rolled/Involute	1-7/8" x 36
G340S	R44KR100X	Straight Cut	2" x 16
	472KS108X	Rolled/Involute	2" x 39
G380S, J400S	047KR100X	Straight Cut	2-1/8" x 20
	472KS109X	Rolled/Involute	2-1/8" x 41
J175S	042KR100X	Straight Cut	1-3/4" x 16
	472KS107X	Rolled/Involute	1-7/8" x 36
J190S, N190*, N210*, N340*	472KS108X	Rolled/Involute	2" x 39
J220S	047KR100X	Straight Cut	2-1/8" x 20
	472KS109X	Rolled/Involute	2-1/8" x 41
J340S, J380S	472KS108X	Rolled/Involute	2" x 39
M230T	MJAKD103X	Rolled/Involute	2-1/8" x 41
M190T, M220T	MJAKD101X	Rolled/Involute	2" x 39
N175*	472KS107X	Rolled/Involute	1-7/8" x 36
N190*, N210*	472KS108X	Rolled/Involute	2" x 39
N400*	472KS109X	Rolled/Involute	2-1/8" x 41
W230S	057KR100X	Straight Cut	2-21/64" x 22
	472KS110X	Rolled/Involute	2-3/8" x 46
W460S	057KR100X	Straight Cut	2-21/64" x 22
	472KS110X	Rolled/Involute	2-3/8" x 46

Note: All Spicer Gold "S" Series products are available only through O.E. channels of distribution.
 All Spicer "N" Series products are available only through Navistar.
 * Not available to independent aftermarket

DIFFERENTIAL CASE KIT

FEATURES

- Made of high strength fine grain nodular iron
- Machined as a set for proper fit
- Machined pilot diameter for proper ring gear location
- Bolt kit included at no additional cost

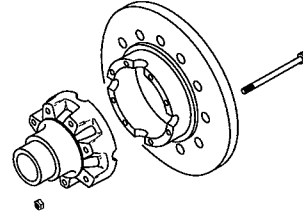

Note: Case kit includes two halves of the case, cap screws, and nut.

DIFFERENTIAL CASE KIT		
Spicer Model	Spicer Part Number	Ratio
F155S, F170S	592224C91	4.44/5.38
	493203C91	5.57/7.17
G155T, G175T	GGAKF102X	All Ratios
	493204C91	3.43/4.44
J175S, G340, G380, J340S, J380S	493205C91	4.78/8.17
	586702C91	3.54
J190S, J210S, J220S, G380, J400S, J340S, J380S	493204C91	3.73/4.44
	493205C91	4.78/7.17
	MJAKF100X	All Ratios
M230T, M190T, M220T, M210T	401 KQ100X	3.06/4.44
	401 KQ101 X	4.56/6.14
N175*, N190*, N210*, N190 School Bus*, N340*, N400*	401 KQ100X	3.06/4.44
	401 KQ101 X	4.56/6.14
N340*, N400*	586703C91	3.54
	493206C91	3.43/4.44
W230, W460S	493207C91	4.78/7.16

Note: All Spicer Gold "S" Series products are available only through O.E. channels of distribution.
 All Spicer "N" Series products are available only through Navistar.
 * Not available to independent aftermarket

This list is not complete, check parts catalog for comprehensive list.

SPICER DIFFERENTIAL MAJOR OVERHAUL KITS

FEATURES

- OEM Bearings, not aftermarket
- All major overhaul kits contain service bulletins

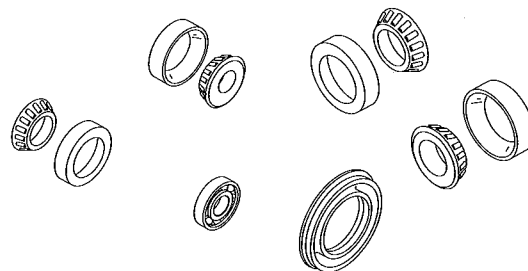

SPICER DIFFERENTIAL MAJOR OVERHAUL KITS			
Spicer Model	Spicer Part Number	Spicer Model	Spicer Part Number
F155	341 KS101	M190T	MJAKA101 X
F170S	341 KS101	M210T	MJAKA101 X
G155T	GGAKA101 X	M220S	MJAKA101 X
G175S	GGAKA101 X	M220T	MJAKA101 X
G175T	GGAKA101 X	M230T	MJAKA101 X
G190S	GGAKA101 X	N175*	401 KS101 X
G300S (FR)	341 KS100	N190*	401 KS101 X
G300S (RR)	341 KS101	N190 School Bus*	401 KS101 X
G340 (FR)	351 KS100	N210*	401 KS101 X
G340 (RR)	472KS101	N340 (FR)*	401 KS100X
G380 (FR)	351 KS100	N340 (RR)*	401 KS101 X
G380 (RR)	472KS101	N400 (FR)*	401 KS100X
J175S	472KS101	N400 (RR)*	401 KS101 X
J190S	472KS101	S135*	360KS100X
J210S	472KS101	S150*	360KS100X
J220S	472KS101	S230*	300KS100X
J340S (FR)	472KS100	S400 (FR)*	390KS105X
J340S (RR)	472KS101	S400 (RR)*	390KS103X
J380S (FR)	472KS100	W230	429KS100
J380S (RR)	472KS101	W230	429KS100
J400S (FR)	472KS100	W460 (FR)	474KS100
J400S (RR)	472KS101	W460 (RR)	474KS101
M190S	MJAKA101 X		

Note: All Spicer Gold "S" Series products are available only through O.E. channels of distribution.
 All Spicer "N" Series products are available only through Navistar.
 * Not available to independent aftermarket

REAR AXLE SEAL CHANGES & SUPERSESSIONS

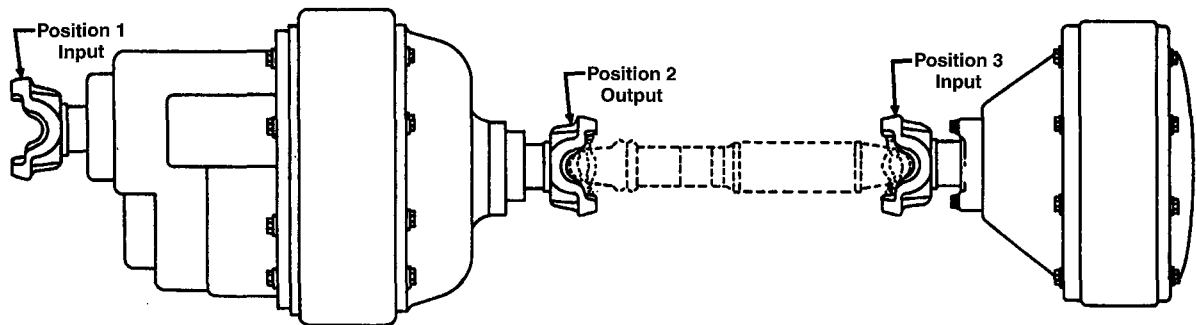

REAR AXLE SEAL CHANGES & SUPERSESSIONS

Spicer Model	Oil Seal	Spicer Part Numbers		
		Original	July, 1991 Change	March, 1993 Change
F155S	Pinion	GGAHH106	029HH100	029HH100
G175S, G190S	Pinion	070HH139	GGAHH109	GGAHH109
M190T, M220T				
M210T, M230T				
J400S, W460S	Forward Input	GGAHH102	472HH100	472HH100
J400S, W460S	Forward Output	GGAHH104	472HH101	472HH101
N175*, N190*	Pinion	GGAHH103	401HH102	401HH102
N190*, W175	Forward Output	401HH101	401HH103	401HH103
N210*, N340*				
N400*, J220S				
J400S, W230				
W460S, J190S				
J190S, J175S				
J380				
N340*, N400*	Forward Input	GGAHH104	401HH104	401HH104

Notes: See page 22 for Half Round End Yoke changes.

Original Seals – Black

July, 1991 Seals – Triple Lip Brown

March, 1993 Seals – Triple Lip Brown with Air Vents

- When changing from the original seal to the March, 1993 seal, the end yoke or flinger must be changed to insure a proper seal.
- New yoke will work with either new or old seal. New seal is recommended.
- Old yoke can only be used with old seal.

All Spicer Gold "S" Series products are available only through O.E. channels of distribution.

All Spicer "N" Series products are available only through Navistar.

* Not available to independent aftermarket

HALF ROUND REAR AXLE END YOKE CHANGES & SUPERSESSIONS



HALF ROUND REAR AXLE END YOKE CHANGES & SUPERSESSIONS

Spicer Model	Series	Spicer Part Numbers	
		Old Yoke Assembly	New Yoke Assembly
F155S	1480	3-4-10431-1X	3-4-12101-1X
	1550	4-4-45671-1X	4-4-6961-1X
	1590	4.9-4-231-1X	90-4-551-1X
	1610	5.4-7291-1X	5-4-8571-1X
J190S	1610	5-4-7221-1X	5-4-8611-1X
J210S	1710	6-4-7221-1X	6-4-8681-1X
J220S	1760	6.3-4-1231-1X	6.3-4-1521-1X
J400S, W460S (RR Input)	1610	5-4-7181-1X	5-4-8691-1X
	1710	6-4-7171-1X	6-4-8761-1X
N175*	1480	3-4-10201-1X	3-4-12141-1X
N190*	1550	4-4-5521-1X	4-4-7001-1X
N210*	1590	4.9-4-251-1X	90-4-591-1X
N340*, N400 (FR Input)*	1610	5-4-7221-1X	5-4-8611-1X
	1710	6-4-7221-1X	6-4-8681-1X
	1760	6.3-4-1231-1X	6.3-4-1521-1X
	1810	6.5-4-3981-1X	6.5-4-4461-1X
N340*, N400 (FR Output*)	1610	5-4-6261	5-4-6261-1
	1710	6-4-6331	6-4-6331-1
	1710	6-4-6321	N/A
N340 (RR Input)*	1610	5-4-7181-1X	5-4-8691-1X
	1710	6-4-7171-1X	6-4-8761-1X
N400 (RR Input)*	1610	5-4-7221-1X	5-4-8611-1X
	1710	6-4-7221-1X	6-4-8681-1X
S135S*, S150S*	1480		3-4-12101-1X
	1550		4-4-6961-1X
	1590		90-4-551-1X
	1610		5-4-8571-1X
S230S*	1710		6-4-8801-1X
W230	1550	4-4-5541-1X	4-4-7111-1X
	1590	4.9-4-271-1X	90-4-611-1X
	1610	5-4-7201-1X	5-4-8631-1X
	1710	6-4-7191-1X	6-4-8701-1X
	1760	6.3-4-1021-1X	6.3-4-1541-1X
	1810	6.5-4-3651-1X	6.5-4-4421-1X
W460S, J380S, J400S (FR Input)	1610	5-4-7211-1X	5-4-8651-1X
	1710	6-4-7211-1X	6-4-8721-1X
	1760	6.3-4-851-1X	6.3-4-1561-1X
	1810	6.5-4-3641-1X	6.5-4-4441-1X
W460S, J380S, J400S (FR Output)	1610	5-4-7251-1X	5-4-8661-1
	1710	6-4-7231-1X	6-4-8731-1
W460S (RR Input)	1710	6-4-7241-1X	6-4-8781-1X

Note: Refer to the Rear Axle Seal Change index on page 21 for additional information
 All Spicer Gold "S" Series products are available only through O.E. channels of distribution.
 All Spicer "N" Series products are available only through Navistar.
 * Not available to independent aftermarket

NEW EXCHANGE CARRIER ASSEMBLIES

NEW EXCHANGE CARRIER ASSEMBLIES

Spicer Model	Spicer Part Number	Axle Spline	Ratio
D135S	579422C91	36	5.38
	572199C91	36	6.17
	572200C91	36	6.67
	572201C91	36	7.17
F155S	029CA104-5X	36	4.33
	029CA104-7X	36	4.56
	029CA104-1X	36	4.78
	029CA104-2X	36	5.57
	029CA104-3X	36	6.50
	029CA104-4X	36	7.17
F170S	029CA104-5X	36	4.33
	029CA104-7X	36	4.56
	029CA104-1X	36	4.78
	029CA104-2X	36	5.57
	029CA104-3X	36	6.50
	029CA104-4X	36	7.17
G175S	GGACA132-1X	36	4.56
	GGACA132-2X	36	4.89
	GGACA132-3X	36	5.57
	GGACA132-4X	36	6.17
	GGACA132-5X	36	6.50
	GGACA132-6X	36	7.17
G175T	GGACA128-31X	36	4.56/6.34
	GGACA128-23X	36	4.89/6.79
	GGACA128-17X	36	5.57/7.15
	GGACA128-18X	36	6.17/8.58
	GGACA128-19X	36	6.50/9.04
	GGACA128-20X	36	7.17/9.97
G175T	GGACA128-31X	36	4.56/6.34
	GGACA128-23X	36	4.89/6.79
	GGACA128-17X	36	5.57/7.15
	GGACA128-18X	36	6.17/8.58
	GGACA128-19X	36	6.50/9.04
	GGACA128-20X	36	7.17/9.97

NEW EXCHANGE CARRIER ASSEMBLIES (cont'd)

NEW EXCHANGE CARRIER ASSEMBLIES (continued)			
Spicer Model	Spicer Part Number	Axle Spline	Ratio
G190S	GGACA134-1X	39	4.56
	GGACA134-2X	39	4.89
	GGACA134-3X	39	5.57
	GGACA134-4X	39	6.17
	GGACA134-5X	39	6.50
	GGACA134-6X	39	7.17
G340S	572236C91	39	3.73
	572237C91	39	3.91
	572238C91	39	4.10
	572239C91	39	4.44
	572234C91	39	4.78
	572241C91	39	5.38
	572242C91	39	6.14
	572243C91	39	6.57
	572244C91	39	7.17
	572245C91	39	8.17
G340S	572261C91	41	3.73
	572262C91	41	3.91
	572263C91	41	4.10
	572264C91	41	4.44
	572265C91	41	4.78
	572266C91	41	5.38
	572267C91	41	6.14
	572268C91	41	6.57
	572269C91	41	7.17
	572270C91	41	8.17
G340/G380 FR	572261C91	41	3.73
	572262C91	41	3.91
	572263C91	41	4.10
	572264C91	41	4.44
	572265C91	41	4.78
	572266C91	41	5.38
	572267C91	41	6.14
	572268C91	41	6.57
572270C91	41	8.17	

NEW EXCHANGE CARRIER ASSEMBLIES (continued)

Spicer Model	Spicer Part Number	Axle Spline	Ratio
J175S	042CA105-1X	36	3.73
	042CA105-2X	36	4.10
	042CA105-3X	36	4.44
	042CA105-4X	36	4.78
	042CA105-5X	36	5.38
	042CA105-6X	36	6.14
	042CA105-7X	36	6.57
	042CA105-8X	36	7.17
	042CA105-9X	36	8.17
J190S	R44CA103-1X	39	3.54
	R44CA103-2X	39	3.73
	R44CA103-11X	39	3.91
	R44CA103-3X	39	4.10
	R44CA103-4X	39	4.44
	R44CA103-5X	39	4.78
	R44CA103-12X	39	5.11
	R44CA103-6X	39	5.38
	R44CA103-7X	39	6.14
	R44CA103-8X	39	6.57
R44CA103-9X	39	7.17	
R44CA103-10X	39	8.17	
J190S	R44CA103-1X	39	3.54
	R44CA103-2X	39	3.73
	R44CA103-11X	39	3.91
	R44CA103-3X	39	4.10
	R44CA103-4X	39	4.44
	R44CA103-5X	39	4.78
	R44CA103-12X	39	5.11
	R44CA103-6X	39	5.38
	R44CA103-7X	39	6.14
	R44CA103-8X	39	6.57
R44CA103-9X	39	7.17	
R44CA103-10X	39	8.17	
J190S, J210S	R44CA103-1X	39	3.54
	R44CA103-2X	39	3.73
	R44CA103-11X	39	3.91
	R44CA103-3X	39	4.10
	R44CA103-4X	39	4.44

NEW EXCHANGE CARRIER ASSEMBLIES (cont'd)

NEW EXCHANGE CARRIER ASSEMBLIES (continued)			
Spicer Model	Spicer Part Number	Axle Spline	Ratio
J190S, J210S	R44CA103-5X	39	4.78
	R44CA103-9X	39	5.11
	R44CA103-6X	39	5.38
	R44CA103-7X	39	6.14
	R44CA103-8X	39	6.57
	R44CA103-10X	39	7.17
	R44CA103-12X	39	8.17
J190S Pinion UP	R44CA105-9X	39	3.54
	R44CA105-1X	39	3.73
	R44CA105-7X	39	3.91
	R44CA105-4X	39	4.10
	R44CA105-2X	39	4.44
	R44CA105-3X	39	4.78
	R44CA105-10X	39	5.11
	R44CA105-5X	39	5.38
	R44CA105-8X	39	5.63
	R44CA105-11X	39	6.14
	R44CA105-12X	39	6.57
J190S	R44CA103-1X	39	3.54
	R44CA103-2X	39	3.73
	R44CA103-11X	39	3.91
	R44CA103-3X	39	4.10
	R44CA103-4X	39	4.44
	R44CA103-5X	39	4.78
	R44CA103-12X	39	5.11
	R44CA103-6X	39	5.38
	R44CA103-7X	39	6.14
	R44CA103-8X	39	6.57
	R44CA103-9X	39	7.17
J220S	047CA107-1X	41	3.54
	047CA107-2X	41	3.73
	047CA107-3X	41	3.91
	047CA107-4X	41	4.10
	047CA107-5X	41	4.44
	047CA107-6X	41	4.78
	047CA107-7X	41	5.38

NEW EXCHANGE CARRIER ASSEMBLIES (continued)

Spicer Model	Spicer Part Number	Axle Spline	Ratio
J220S	047CA107-8X	41	6.14
	047CA107-9X	41	6.57
	047CA107-10X	41	7.17
J220S	047CA107-1X	41	3.54
	047CA107-2X	41	3.73
	047CA107-3X	41	3.91
	047CA107-4X	41	4.10
	047CA107-5X	41	4.44
	047CA107-6X	41	4.78
	047CA107-7X	41	5.38
	047CA107-8X	41	6.14
	047CA107-9X	41	6.57
	047CA107-10X	41	7.17
	047CA107-11X	41	8.17
J220S	047CA107-1X	41	3.54
	047CA107-2X	41	3.73
	047CA107-3X	41	3.91
	047CA107-4X	41	4.10
	047CA107-5X	41	4.44
	047CA107-6X	41	4.78
	047CA107-7X	41	5.38
	047CA107-8X	41	6.14
	047CA107-9X	41	6.57
	047CA107-10X	41	7.17
	047CA107-11X	41	8.17
J340S/J380S FR	476CA110-1X	39	3.06
	476CA110-2X	39	3.21
	476CA110-3X	39	3.42
	476CA110-4X	39	3.54
	476CA110-5X	39	3.73
	476CA110-6X	39	3.91
	476CA110-7X	39	4.10
	476CA110-8X	39	4.44
	476CA110-9X	39	4.78
	476CA110-10X	39	5.11
	476CA110-11X	39	5.38
	476CA110-12X	39	6.14

NEW EXCHANGE CARRIER ASSEMBLIES (cont'd)

NEW EXCHANGE CARRIER ASSEMBLIES (continued)			
Spicer Model	Spicer Part Number	Axle Spline	Ratio
J380S	476CA110-1X	39	3.54
	476CA110-2X	39	3.73
	476CA110-3X	39	3.91
	476CA110-4X	39	4.10
	476CA110-5X	39	4.44
	476CA110-6X	39	4.78
	476CA110-7X	39	5.38
	476CA110-8X	39	6.14
	476CA110-9X	39	6.57
	476CA110-10X	39	7.17
J400S FR	472CA115-1X	41	3.54
	472CA115-2X	41	3.73
	472CA115-3X	41	3.91
	472CA115-4X	41	4.10
	472CA115-5X	41	4.44
	472CA115-6X	41	4.78
	472CA115-7X	41	5.38
	472CA115-8X	41	6.14
	472CA115-9X	41	6.57
	472CA115-10X	41	7.17
	472CA115-11X	41	8.17
J400S	047CA107-1X	41	3.54
	047CA107-2X	41	3.73
	047CA107-3X	41	3.91
	047CA107-4X	41	4.10
	047CA107-5X	41	4.44
	047CA107-6X	41	4.78
	047CA107-7X	41	5.38
	047CA107-8X	41	6.14
	047CA107-9X	41	6.57
	047CA107-10X	41	7.17
J400S	472CA115-1X	41	3.54
	472CA115-2X	41	3.73
	472CA115-3X	41	3.91
	472CA115-4X	41	4.10
	472CA115-5X	41	4.44
	472CA115-6X	41	4.78
	472CA115-7X	41	5.38

NEW EXCHANGE CARRIER ASSEMBLIES (continued)

Spicer Model	Spicer Part Number	Axle Spline	Ratio
J400S	472CA115-8X	41	6.14
	472CA115-9X	41	6.57
	472CA115-10X	41	7.17
	472CA115-11X	41	8.17
M190S	MJACA128-4X	39	4.56
	MJACA128-5X	39	4.89
	MJACA128-6X	39	5.29
	MJACA128-7X	39	5.57
	MJACA128-8X	39	6.14
	MJACA128-9X	39	6.50
	MJACA128-10X	39	7.17
M190T	MJACA122-54X	39	3.70/5.05
	MJACA122-71X	39	3.90/5.32
	MJACA122-53X	39	4.11/5.60
	MJACA122-37X	39	4.56/6.21
	MJACA122-23X	39	4.89/6.66
	MJACA122-38X	39	5.29/7.21
	MJACA122-1X	39	5.57/7.60
	MJACA122-2X	39	6.14/8.38
	MJACA122-3X	39	6.50/8.87
	MJACA122-4X	39	7.17/9.77
M190T	MJACA122-54X	39	3.70/5.05
	MJACA122-71X	39	3.90/5.32
	MJACA122-53X	39	4.11/5.60
	MJACA122-37X	39	4.56/6.21
	MJACA122-23X	39	4.89/6.66
	MJACA122-38X	39	5.29/7.21
	MJACA122-1X	39	5.57/7.60
	MJACA122-2X	39	6.14/8.38
	MJACA122-3X	39	6.50/8.87
	MJACA122-4X	39	7.17/9.77
M220S	MJACA129-1X	41	3.70
	MJACA129-2X	41	3.90
	MJACA129-3X	41	4.11
	MJACA129-4X	41	4.56
	MJACA129-5X	41	4.89
	MJACA129-6X	41	5.29

NEW EXCHANGE CARRIER ASSEMBLIES (cont'd)

NEW EXCHANGE CARRIER ASSEMBLIES (continued)			
Spicer Model	Spicer Part Number	Axle Spline	Ratio
M220S	MJACA129-7X	41	5.57
	MJACA129-8X	41	6.14
	MJACA129-9X	41	6.50
	MJACA129-10X	41	7.17
M220T	MJACA124-7X	41	4.56/6.21
	MJACA124-5X	41	4.89/6.66
	MJACA124-6X	41	5.29/7.21
	MJACA124-1X	41	5.57/7.60
	MJACA124-2X	41	6.14/8.38
	MJACA124-3X	41	6.50/8.87
M230T	MJACA124-7X	41	4.56/6.21
	MJACA124-5X	41	4.89/6.66
	MJACA124-6X	41	5.29/7.21
	MJACA124-1X	41	5.57/7.60
	MJACA124-2X	41	6.14/8.38
	MJACA124-3X	41	6.50/8.87
N175*	175CA104-1X	36	3.06
	175CA104-2X	36	3.21
	175CA104-3X	36	3.42
	175CA104-4X	36	3.54
	175CA104-5X	36	3.73
	175CA104-6X	36	3.91
	175CA104-7X	36	4.10
	175CA104-8X	36	4.44
	175CA104-10X	36	4.78
	175CA104-15X	36	5.11
	175CA104-13X	36	5.38
	175CA104-17X	36	5.63
	175CA104-14X	36	6.14
	175CA105-1X	36	6.50
175CA105-2X	36	7.17	
N190*	190CA104-1X	39	3.06
	190CA104-2X	39	3.21
	190CA104-3X	39	3.42
	190CA104-4X	39	3.54

Note: All Spicer Gold "S" Series products are available only through O.E. channels of distribution.

All Spicer "N" Series products are available only through Navistar.

* Not available to independent aftermarket

NEW EXCHANGE CARRIER ASSEMBLIES (continued)

Spicer Model	Spicer Part Number	Axle Spline	Ratio
N190*	190CA104-5X	39	3.73
	190CA104-6X	39	3.91
	190CA104-7X	39	4.10
	190CA104-8X	39	4.44
	190CA104-10X	39	4.78
	190CA104-15X	39	5.11
	190CA104-13X	39	5.38
	190CA104-17X	39	5.63
	190CA104-14X	39	6.14
	190CA105-1X	39	6.50
190CA105-2X	39	7.17	
N190*	190CA104-1X	39	3.06
	190CA104-2X	39	3.21
	190CA104-3X	39	3.42
	190CA104-4X	39	3.54
	190CA104-5X	39	3.73
	190CA104-6X	39	3.91
	190CA104-7X	39	4.10
	190CA104-8X	39	4.44
	190CA104-10X	39	4.78
	190CA104-15X	39	5.11
	190CA104-13X	39	5.38
	190CA104-17X	39	5.63
	190CA104-14X	39	6.14
	190CA105-1X	39	6.50
190CA105-2X	39	7.17	
N340*	340CA154-1X	39	3.06
	340CA154-2X	39	3.21
	340CA154-3X	39	3.42
	340CA154-4X	39	3.54
	340CA154-5X	39	3.73
	340CA154-6X	39	3.91
	340CA154-7X	39	4.10
	340CA154-8X	39	4.44
	340CA154-10X	39	4.78
	340CA154-29X	39	5.11
	340CA154-13X	39	5.38
	340CA154-33X	39	5.63
	340CA154-14X	39	6.14

Note: All Spicer Gold "S" Series products are available only through O.E. channels of distribution.
 All Spicer "N" Series products are available only through Navistar.
 * Not available to independent aftermarket

NEW EXCHANGE CARRIER ASSEMBLIES (cont'd)

NEW EXCHANGE CARRIER ASSEMBLIES (continued)			
Spicer Model	Spicer Part Number	Axle Spline	Ratio
N400*	401CA151-1X	40	3.06
	401CA151-2X	40	3.21
	401CA151-3X	40	3.42
	401CA151-4X	40	3.54
	401CA151-5X	40	3.73
	401CA151-6X	40	3.91
	401CA151-7X	40	4.10
	401CA151-8X	40	4.44
	401CA151-10X	40	4.78
	401CA151-29X	40	5.11
	401CA151-13X	40	5.38
	401CA151-33X	40	5.63
401CA151-14X	40	6.14	
N400*	401CA112-1X	40	3.06
	401CA112-2X	40	3.21
	401CA112-3X	40	3.42
	401CA112-4X	40	3.54
	401CA112-5X	40	3.73
	401CA112-6X	40	3.91
	401CA112-7X	40	4.10
	401CA112-8X	40	4.44
	401CA112-10X	40	4.78
	401CA112-15X	40	5.11
	401CA112-13X	40	5.38
	401CA112-14X	40	6.14
S135/150S*	360CA100-15X	36	2.81
	360CA100-1X	36	3.07
	360CA100-2X	36	3.21
	360CA100-3X	36	3.38
	360CA100-4X	36	3.54
	360CA100-5X	36	3.73
	360CA100-6X	36	3.91
	360CA100-7X	36	4.10
	360CA100-8X	36	4.44
	360CA100-9X	36	4.78
	360CA100-17X	36	5.13
	360CA100-10X	36	5.38
360CA100-11X	36	6.14	
360CA100-12X	36	6.43	

Note: All Spicer Gold "S" Series products are available only through O.E. channels of distribution.
 All Spicer "N" Series products are available only through Navistar.
 * Not available to independent aftermarket

NEW EXCHANGE CARRIER ASSEMBLIES (continued)

Spicer Model	Spicer Part Number	Axle Spline	Ratio
S230S*	300CA100-1X	46	3.07
	300CA100-2X	46	3.21
	300CA100-7X	46	3.54
	300CA100-3X	46	3.73
	300CA100-8X	46	3.91
	300CA100-9X	46	4.10
	300CA100-5X	46	4.44
	300CA100-6X	46	4.78
S400*	390CA100-1X	41	2.81
	390CA100-2X	41	2.92
	390CA100-3X	41	3.07
	390CA100-4X	41	3.21
	390CA100-5X	41	3.42
	390CA100-6X	41	3.73
	390CA100-7X	41	3.91
	390CA100-8X	41	4.10
	390CA100-9X	41	4.44
	390CA100-10X	41	4.78
S400*	390CA101-1X	41	2.81
	390CA101-2X	41	2.92
	390CA101-3X	41	3.07
	390CA101-4X	41	3.21
	390CA101-5X	41	3.42
	390CA101-6X	41	3.73
	390CA101-7X	41	3.91
	390CA101-8X	41	4.10
	390CA101-9X	41	4.44
	390CA101-10X	41	4.78
W230S	057CA108-1X	46	3.54
	057CA108-2X	46	3.73
	057CA108-3X	46	3.91
	057CA108-4X	46	4.10
	057CA108-5X	46	4.44
	057CA108-6X	46	4.78
	057CA108-7X	46	5.38
	057CA108-8X	46	6.14
	057CA108-9X	46	6.57
	057CA108-10X	46	7.17

Note: All Spicer Gold "S" Series products are available only through O.E. channels of distribution.
 All Spicer "N" Series products are available only through Navistar.
 * Not available to independent aftermarket

NEW EXCHANGE CARRIER ASSEMBLIES (cont'd)

NEW EXCHANGE CARRIER ASSEMBLIES (continued)			
Spicer Model	Spicer Part Number	Axle Spline	Ratio
W230	057CA108-1X	46	3.54
	057CA108-2X	46	3.73
	057CA108-3X	46	3.91
	057CA108-4X	46	4.10
	057CA108-5X	46	4.44
	057CA108-6X	46	4.78
	057CA108-7X	46	5.38
	057CA108-8X	46	6.14
	057CA108-9X	46	6.57
	057CA108-10X	46	7.17
W230S	057CA108-1X	46	3.54
	057CA108-2X	46	3.73
	057CA108-3X	46	3.91
	057CA108-4X	46	4.10
	057CA108-5X	46	4.44
	057CA108-6X	46	4.78
	057CA108-7X	46	5.38
	057CA108-8X	46	6.14
	057CA108-9X	46	6.57
	057CA108-10X	46	7.17
W460S FR	474CA113-1X	46	3.54
	474CA113-2X	46	3.73
	474CA113-3X	46	3.91
	474CA113-4X	46	4.10
	474CA113-5X	46	4.44
	474CA113-6X	46	4.78
	474CA113-7X	46	5.38
	474CA113-8X	46	6.14
	474CA113-9X	46	6.57
	474CA113-10X	46	7.17
W460S	474CA113-1X	46	3.54
	474CA113-2X	46	3.73
	474CA113-3X	46	3.91
	474CA113-4X	46	4.10
	474CA113-5X	46	4.44
	474CA113-6X	46	4.78
	474CA113-7X	46	5.38
	474CA113-8X	46	6.14
	474CA113-9X	46	6.57
	474CA113-10X	46	7.17